

GROUP 1.000

COOLANT — GRILLE

OIL SYSTEMS

ILLUSTRATION INDEX

Description	Page
Water Pump	1
Belt and Pulley Application	2-8
Radiator Charts	9-12
Oil Pump	13
Radiator Grille	16-21

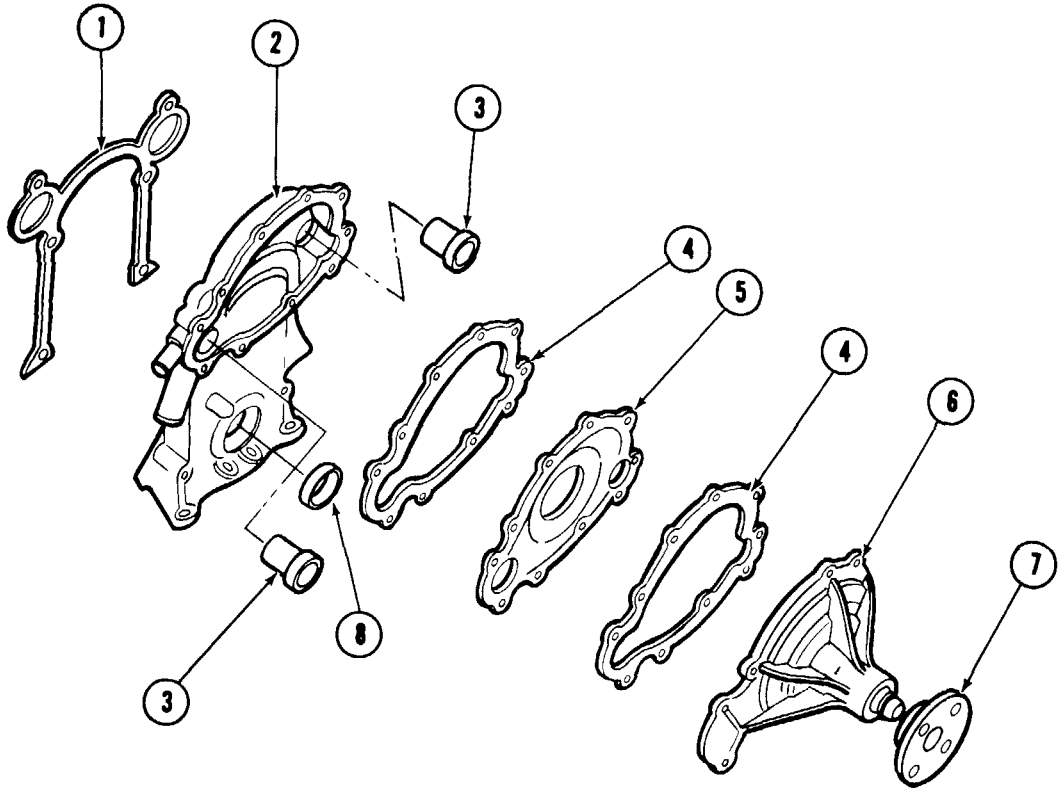

1969-76 8-CYL. TIMING CHAIN COVER & WATER PUMP

Key	Part Name	Group No.	Key	Part Name	Group No.
1	GASKET PKG., Timing Chain Cover	0.207	5	HOUSING, Pump Internal	1.069
2	COVER ASM., Timing Chain	0.206	6	PUMP ASM., Water (Incl. #4)	1.069
3	SLEEVE & SEAL ASM., Pump Outlet	1.069	7	HUB, Water Pump and Fan	1.062
4	GASKET, Pump to Timing Chain Cover	1.079	8	SEAL, Timing Chain Cover Oil	0.213

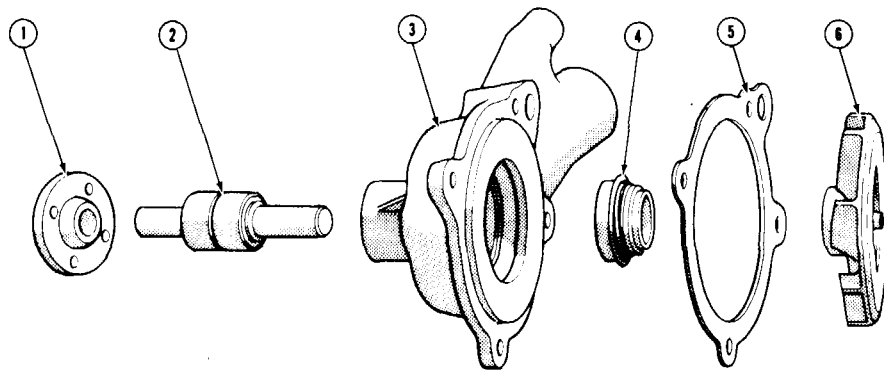

1970-76 6-CYL. ENGINE WATER PUMP

Key	Part Name	Group No.	Key	Part Name	Group No.
1	HUB, Water Pump and Fan	1.062	4	SEAL ASM., Water Pump	1.123
2	SHAFT & BEARING ASM., Water Pump	1.105	5	GASKET, Water Pump to Block	1.079
3	HOUSING, Water Pump - Inc. #1-2-4-5-6	1.069	6	ROTOR, Water Pump	1.109

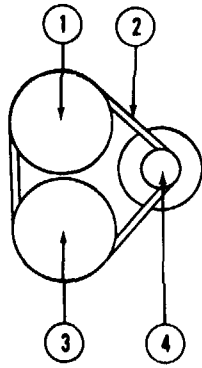

STANDARD CAR

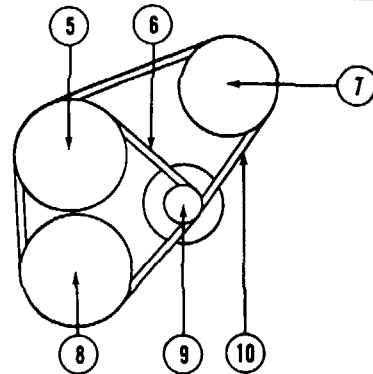

POWER STEERING

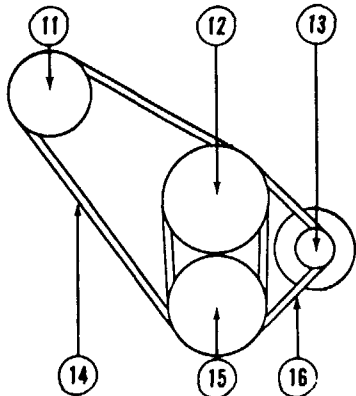

AIR CONDITIONING

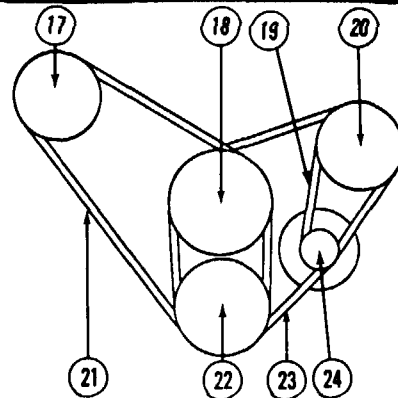

AIR CONDITIONING & POWER STEERING

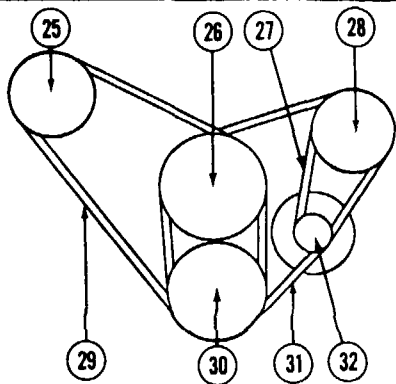

AIR INJECTION & AIR CONDITIONING

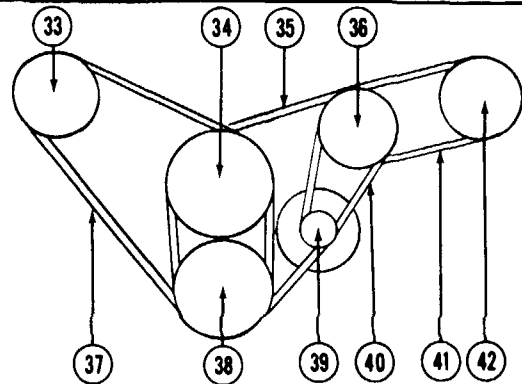

AIR COND., POWER STRG. & A.I.R.

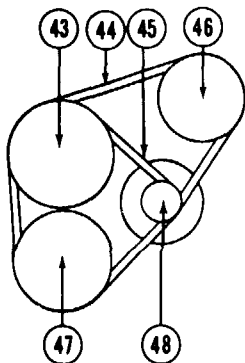

AIR INJECTION

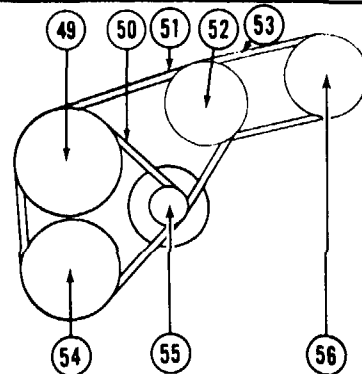

AIR INJECTION & POWER STEERING

1967 FIREBIRD O.H.C. 6-CYL. ENGINE PULLEY & BELT APPLICATION



1967 FIREBIRD O.H.C. 6-CYL. ENGINE PULLEY & BELT APPLICATION

Key	Group No.	Part No.	Description	Size
1	1.062	9782955	PULLEY (1-Groove)	7 3/16" dia.
2	1.066	9433731	BELT	15/32" x 39 1/2"
3	0.659	9778553	BALANCER, 1 Bbl. (1-Groove)	6 3/4" dia.
	0.659	9778551	BALANCER, 4 Bbl. (2-Groove)	6 3/4" dia.
4	2.274	1949355	PULLEY (1-Groove)	2 1/2" dia.
5	1.062	9778559	PULLEY (2-Groove)	7 1/8" dia.
6	1.066	9433731	BELT	15/32" x 39 1/2"
7	6.655	9778555	PULLEY (1-Groove)	5 11/16" dia.
8	0.659	9778553	BALANCER, 1 Bbl. (1-Groove)	6 3/4" dia.
	0.659	9778557	PULLEY, 1 Bbl. (1-Groove)	6 3/4" dia.
	0.659	9778551	BALANCER, 4 Bbl. (2-Groove)	6 3/4" dia.
9	2.274	1968354	PULLEY (2-Groove)	2 1/2" dia.
10	1.066	9433755	BELT	1 2" x 52"
11	9.180	5914745	PULLEY & BEARING (1-Groove)	5 41/64" dia.
12	1.062	9789022	PULLEY (2-Groove)	6 1/4" dia.
13	2.274	1949355	PULLEY (1-Groove)	2 1/2" dia.
14	1.066	9785155	BELT	1/2" x 57 1/2"
15	0.659	9433766	BALANCER, 1 Bbl. (1-Groove)	6 3/4" dia.
	0.659	9778557	PULLEY, 1 Bbl. (1-Groove)	6 3/4" dia.
	0.659	9778551	BALANCER, 4 Bbl. (2-Groove)	6 3/4" dia.
16	1.066	9789079	BELT	3 8" x 38"
17	9.180	5914745	PULLEY & BEARING (1-Groove)	5 41/64" dia.
18	1.062	9789022	PULLEY (2-Groove)	6 1/4" dia.
19	1.066	9779516	BELT	3/8" x 27 5/8"
20	6.655	9778562	PULLEY (2-Groove)	5 11/16" dia.
21	1.066	9433766	BELT	1/2" x 57 1/2"
22	0.659	9778553	BALANCER, 1 Bbl. (1-Groove)	6 3/4" dia.
	0.659	9778557	PULLEY, 1 Bbl. (1-Groove)	6 3/4" dia.
	0.659	9778551	BALANCER, 4 Bbl. (2-Groove)	6 3/4" dia.
23	1.066	9786984	BELT	1/2" x 51 1/2"
24	2.274	1964758	PULLEY (2-Groove)	2 5/8" dia.
25	9.180	5914745	PULLEY & BEARING (1-Groove)	5 41/64" dia.
26	1.062	9778559	PULLEY (2-Groove)	7 1/8" dia.
27	1.066	9433708	BELT	3/8" x 27 5/8"
28	3.650	9778561	PULLEY (1-Groove)	5 11/16" dia.
29	1.066	9433766	BELT	1/2" x 57 1/2"
30	0.659	9778553	BALANCER, 1 Bbl. (1-Groove)	6 3/4" dia.
	0.659	9778557	PULLEY, 1 Bbl. (1-Groove)	6 3/4" dia.
	0.659	9778551	BALANCER, 4 Bbl. (2-Groove)	6 3/4" dia.
31	1.066	9433756	BELT	1/2" x 51 1/2"
32	2.274	1968354	PULLEY (2-Groove)	2 1/2" dia.
33	9.180	5914745	PULLEY & BEARING (1-Groove)	5 41/64" dia.
34	1.062	9789022	PULLEY (2-Groove)	6 1/4" dia.
35	1.066	9433756	BELT	1/2" x 51 1/2"
36	6.655	9788972	PULLEY (3-Groove)	5 5/8" dia.
37	1.066	9433766	BELT	1/2" x 57 1/2"
38	0.659	9778553	BALANCER, 1 Bbl. (1-Groove)	6 3/4" dia.
	0.659	9778557	PULLEY, 1 Bbl. (1-Groove)	6 3/4" dia.
	0.659	9778551	BALANCER, 4 Bbl. (2-Groove)	6 3/4" dia.
39	2.274	1949357	PULLEY (2-Groove)	2 5/8" dia.
40	1.066	9433708	BELT	3/8" x 27 5/8"
41	1.066	N.L.A.	BELT	3/8" x 31 1/4"
42	3.650	9782690	PULLEY (1-Groove)	5 11/16" dia.
43	1.062	9778559	PULLEY (2-Groove)	7 1/8" dia.
44	1.066	9433755	BELT	1 2" x 52"
45	1.066	9433731	BELT	15/32" x 39 1/2"
46	3.650	9778560	PULLEY (1-Groove)	5 11/16" dia.
47	0.659	9778553	BALANCER, 1 Bbl. (1-Groove)	6 3/4" dia.
	0.659	9778557	PULLEY, 1 Bbl. (1-Groove)	6 3/4" dia.
	0.659	9778551	BALANCER, 4 Bbl. (2-Groove)	6 3/4" dia.
48	2.274	1968354	PULLEY (2-Groove)	2 5/8" dia.
49	1.062	9778559	PULLEY (2-Groove)	7 1/8" dia.
50	1.066	9433731	BELT	15/32" x 39 1/2"
51	1.066	9433755	BELT	1 2" x 52"
52	6.655	9778562	PULLEY (2-Groove)	5 11/16" dia.
53	1.066	N.L.A.	BELT	3/8" x 31 1/4"
54	0.659	9778553	BALANCER, 1 Bbl. (1-Groove)	6 3/4" dia.
	0.659	9778557	PULLEY, 1 Bbl. (1-Groove)	6 3/4" dia.
	0.659	9778551	BALANCER, 4 Bbl. (2-Groove)	6 3/4" dia.
55	2.274	1968354	PULLEY (2-Groove)	2 5/8" dia.
56	3.650	9782690	PULLEY (1-Groove)	5 11/16" dia.

N.L.A. — NO LONGER AVAILABLE

GM FIREBIRD
PARTS CATALOGUE

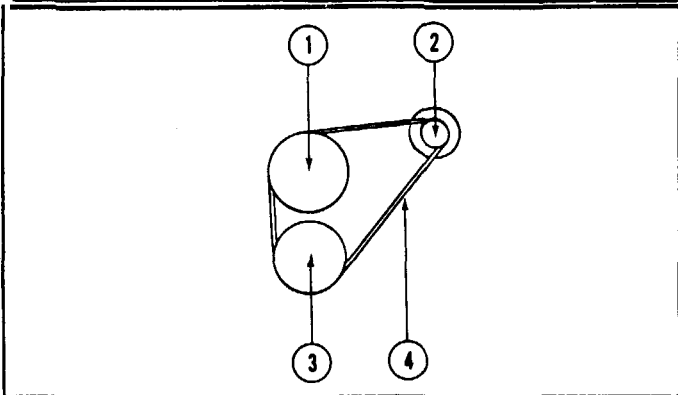

STANDARD CAR

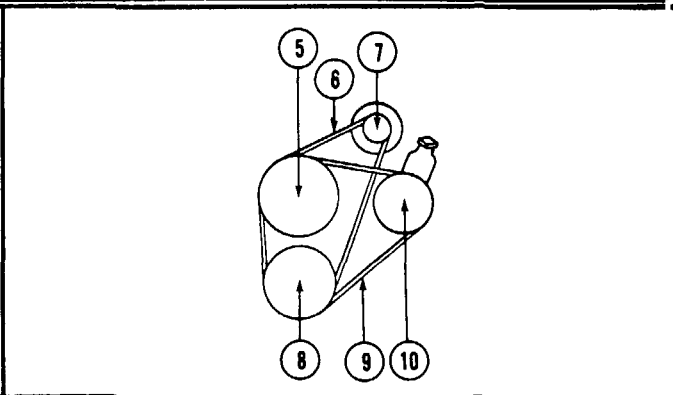

POWER STEERING

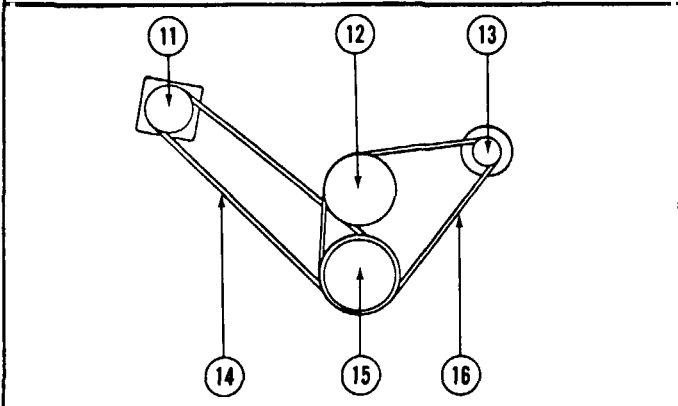

AIR CONDITIONING

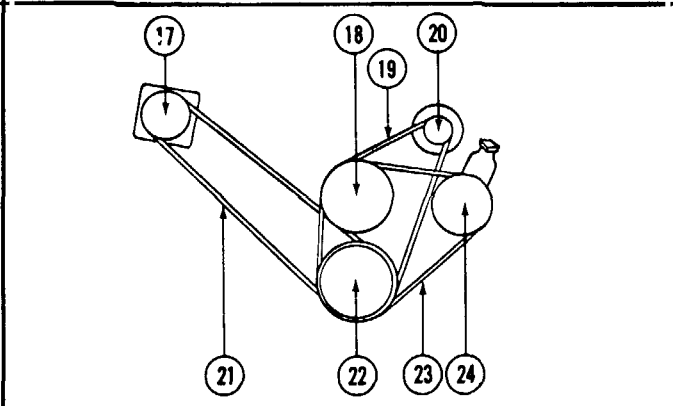

AIR CONDITIONING & POWER STEERING

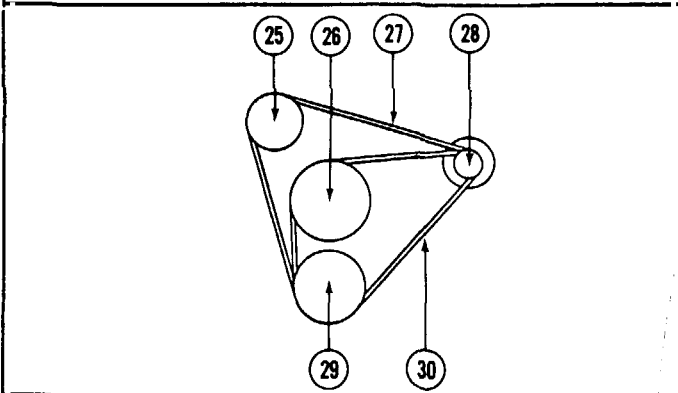

AIR INJECTION

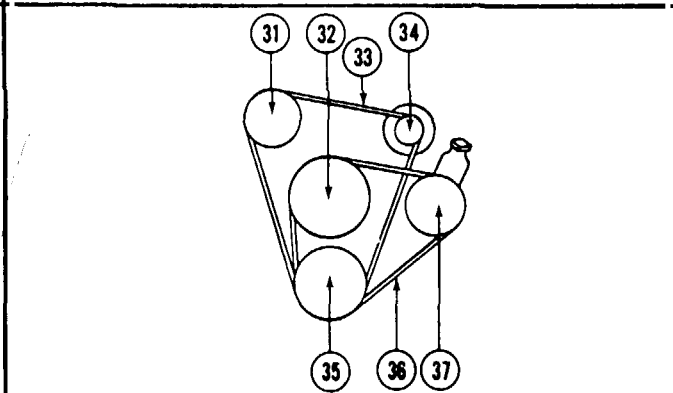

AIR INJECTION & POWER STEERING

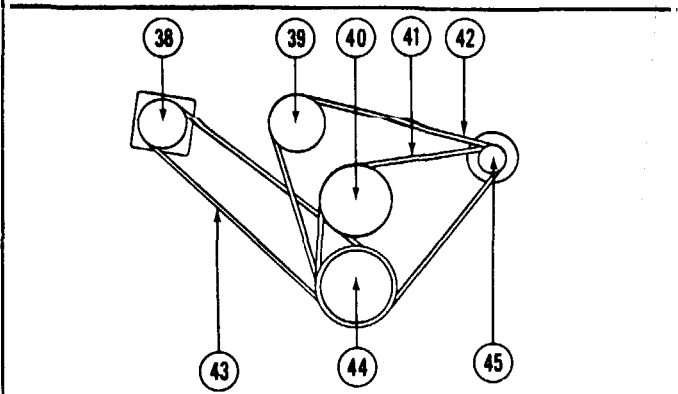

AIR INJECTION & AIR CONDITIONING

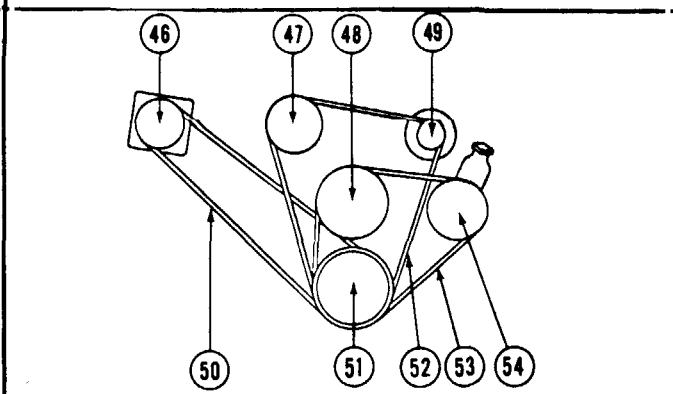

AIR COND., POWER STRG. & A.I.R.

1967 FIREBIRD 8-CYL. ENGINE PULLEY & BELT APPLICATION

1967 FIREBIRD 8-CYL. ENGINE PULLEY & BELT APPLICATION

Key	Group No.	Part No.	Description	Size
1	1.062	9778808	FAN PULLEY (1-Groove).....	8" dia.
2	2.274	1949357	PULLEY (1-Groove).....	2 3/4" dia.
3	0.659	9786714	BALANCER (1-Groove).....	7 3/8" dia.
4	1.066	9433761	BELT.....	3/8" x 54 1/4"
5	1.062	9786819	PULLEY (2-Groove).....	8" dia.
6	1.066	6263720	BELT.....	3/8" x 50"
7	2.274	1949357	PULLEY (1-Groove).....	2 3/4" dia.
8	0.659	9786714	BALANCER (2-Groove).....	7 3/8" dia.
9	1.066	3881871	BELT.....	3/8" x 52"
10	6.655	9786900	PULLEY.....	5 7/8" dia.
11	9.180	5914730	PULLEY & BEARING ASM.....	4 7/8" dia.
12	1.062	9786909	PULLEY (2-Groove).....	7 1/8" dia.
13	2.274	1949357	PULLEY (1-Groove).....	2 3/4" dia.
14	1.066	9433766	BELT.....	1/2" x 59"
15	0.659	9786908	BALANCER (3-Groove).....	8" dia.
16	1.066	9433761	BELT.....	3/8" x 54 1/4"
17	9.180	5914730	PULLEY & BEARING ASM.....	4 7/8" dia.
18	1.062	9786909	PULLEY (2-Groove).....	7 1/8" dia.
19	1.066	391201	BELT.....	3/8" x 50"
20	2.274	1949357	PULLEY (1-Groove).....	2 3/4" dia.
21	1.066	9433731	BELT.....	1/2" x 59"
22	0.659	9786908	BALANCER (3-Groove).....	8" dia.
23	1.066	9433758	BELT.....	1/2" x 53 1/2"
24	6.655	9786901	PULLEY (1-Groove).....	7 1/8" dia.
25	3.650	9785478	PULLEY (1-Groove).....	6 1/8" dia.
26	1.062	9786819	PULLEY (2-Groove).....	8" dia.
27	1.066	N.L.A.	BELT.....	3/8" x 69"
28	2.274	1967651	PULLEY (2-Groove).....	2 5/8" dia.
29	0.659	9786714	BALANCER (2-Groove).....	7 3/8" dia.
30	1.066	N.L.A.	BELT.....	3/8" x 57"
31	3.650	9785478	PULLEY (1-Groove).....	6 1/8" dia.
32	1.062	9786819	PULLEY (2-Groove).....	8" dia.
33	1.066	3394006	BELT.....	3/8" x 61 3/16"
34	2.274	1949357	PULLEY (1-Groove).....	2 3/4" dia.
35	0.659	9786714	BALANCER (2-Groove).....	7 3/8" dia.
36	1.066	3881871	BELT.....	3/8" x 52"
37	6.655	9786900	PULLEY.....	5 7/8" dia.
38	9.180	5914730	PULLEY & BEARING ASM.....	4 7/8" dia.
39	3.650	9782664	PULLEY (1-Groove).....	5 5/8" dia.
40	1.062	9788886	PULLEY (2-Groove).....	5 11/16" dia.
41	1.066	9433765	BELT.....	1/2" x 56 5/8"
42	1.066	9786812	BELT.....	3/8" x 69"
43	1.066	9782705	BELT.....	1/2" x 59"
44	0.659	9786908	BALANCER (3-Groove).....	8" dia.
45	2.274	1967651	PULLEY (2-Groove).....	2 5/8" dia.
46	9.180	5914730	PULLEY & BEARING ASM.....	4 7/8" dia.
47	3.650	9782664	PULLEY (1-Groove).....	5 5/8" dia.
48	1.062	9788886	PULLEY (2-Groove).....	5 11/16" dia.
49	2.274	1949357	PULLEY (1-Groove).....	2 3/4" dia.
50	1.066	9433775	BELT.....	1/2" x 59"
51	0.659	9786908	BALANCER (3-Groove).....	8" dia.
52	1.066	9433755	BELT.....	3/8" x 61 3/16"
53	1.066	9433759	BELT.....	1/2" x 53"
54	6.655	9786901	PULLEY (1-Groove).....	7 1/8" dia.

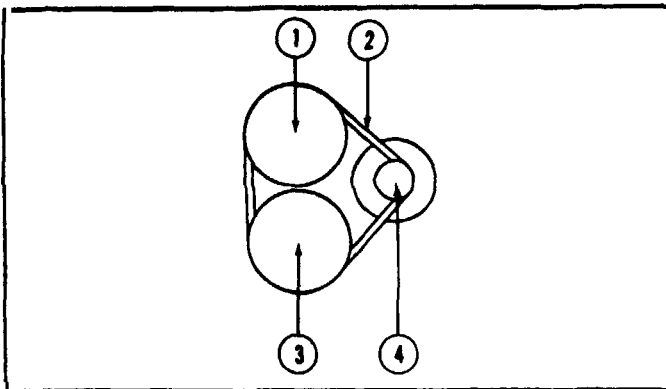

STANDARD CAR

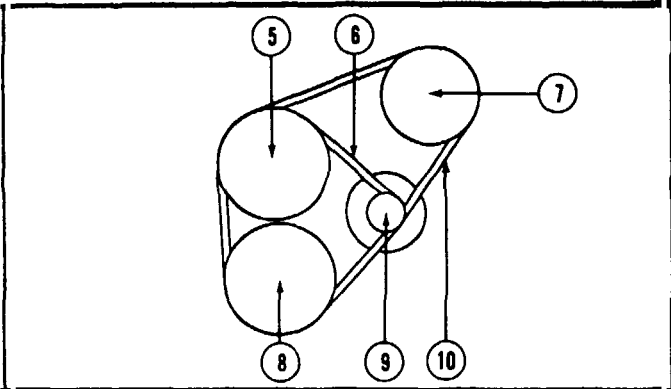

POWER STEERING

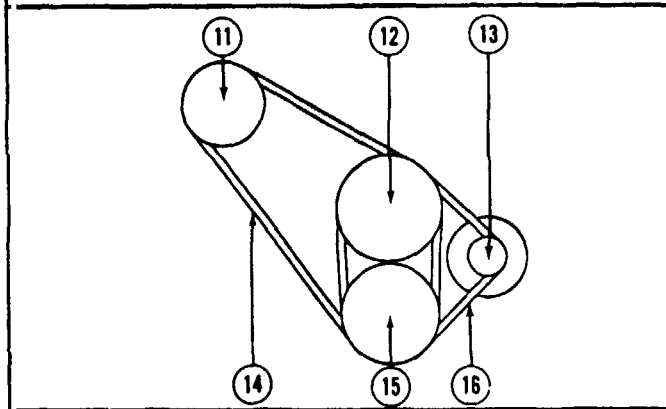

AIR CONDITIONING

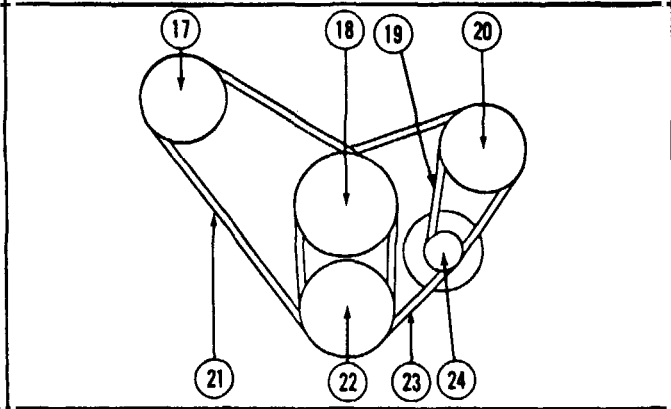

AIR CONDITIONING & POWER STEERING

1968-69 FIREBIRD O.H.C. 6 CYL. ENGINE PULLEY & BELT APPLICATION

KEY	GROUP NO.	PART NO.		DESCRIPTION	SIZE	
		1968	1969		1968	1969
1	1.062	9782955	9797027	PULLEY (1-Groove)	7 ¹ / ₈ " Dia.	7 ¹ / ₈ " Dia.
2	1.066	9433731	9433731	BELT	15/32" x 39 ¹ / ₂ "	15/32" x 39 ¹ / ₂ "
3	0.659	9791717	9791717	BALANCER, 1 BBL. (2-Groove)	6 ³ / ₄ " Dia.	6 ³ / ₄ " Dia.
4	0.659	9792484	9792484	BALANCER, 4 BBL. (2-Groove)	8 ³ / ₄ " Dia.	8 ³ / ₄ " Dia.
4	2.274	1949355	1949355	PULLEY (1-Groove)	2 ¹ / ₂ " Dia.	2 ¹ / ₂ " Dia.
5	1.062	9778559	9797029	PULLEY (2-Groove)	7 ¹ / ₈ " Dia.	7 ¹ / ₈ " Dia.
6	1.066	9433731	9433731	BELT	15/32" x 39 ¹ / ₂ "	15/32" x 39 ¹ / ₂ "
7	6.655	9778555	9778555	PULLEY (1-Groove)	5 ¹ / ₁₆ " Dia.	5 ¹ / ₁₆ " Dia.
8	0.659	9791717	9791717	BALANCER, 1 Bbl. (2-Groove)	6 ³ / ₄ " Dia.	6 ³ / ₄ " Dia.
8	0.659	9792484	9792484	BALANCER, 4 Bbl. (2-Groove)	8 ³ / ₄ " Dia.	8 ³ / ₄ " Dia.
9	2.274	1968354	1968354	PULLEY (2-Groove)	2 ¹ / ₂ " Dia.	2 ¹ / ₂ " Dia.
10	1.066	3881871	3881871	BELT	1/2" x 52"	1/2" x 52"
11	9.180	5914745	5914745	PULLEY & BEARING (1-Groove)	5-41/64" Dia.	5-41/64" Dia.
12	1.062	9789022	9797028	PULLEY (2-Groove)	6 ¹ / ₄ " Dia.	6 ¹ / ₄ " Dia.
13	2.274	1949355	1949355	PULLEY (1-Groove)	2 ¹ / ₂ " Dia.	2 ¹ / ₂ " Dia.
14	1.066	9433766	9433766	BELT	1/2" x 57 ¹ / ₂ "	1/2" x 57 ¹ / ₂ "
15	0.659	9791717	9791717	BALANCER, 1 Bbl. (2-Groove)	6 ³ / ₄ " Dia.	6 ³ / ₄ " Dia.
15	0.659	9792484	9792484	BALANCER, 4 Bbl. (2-Groove)	8 ³ / ₄ " Dia.	8 ³ / ₄ " Dia.
16	1.066	9789079	9789079	BELT	3/8" x 39"	3/8" x 39"
17	9.180	5914745	5914745	PULLEY & BEARING (1-Groove)	5-41/64" Dia.	5 ³ / ₁₆ " Dia.
18	1.062	9789022	9797028	PULLEY (2-Groove)	6 ¹ / ₄ " Dia.	6 ¹ / ₄ " Dia.
19	1.066	9433708	9433708	BELT	3/8" x 27 ³ / ₈ "	3/8" x 27 ³ / ₈ "
20	6.655	9778562	9778562	PULLEY (2-Groove)	5 ¹ / ₁₆ " Dia.	5 ¹ / ₁₆ " Dia.
21	1.066	9433766	9433766	BELT	1/2" x 57 ¹ / ₂ "	1/2" x 57 ¹ / ₂ "
22	0.659	9791717	9791717	BALANCER (2-Groove)	6 ³ / ₄ " Dia.	6 ³ / ₄ " Dia.
22	0.659	9792484	9792484	BALANCER (2-Groove)	8 ³ / ₄ " Dia.	8 ³ / ₄ " Dia.
23	1.066	9433756	9433756	BELT	1/2" x 51 ¹ / ₂ "	1/2" x 51 ¹ / ₂ "
24	2.274	1964758	1964758	PULLEY (2-Groove)	2 ³ / ₈ " Dia.	2 ³ / ₈ " Dia.

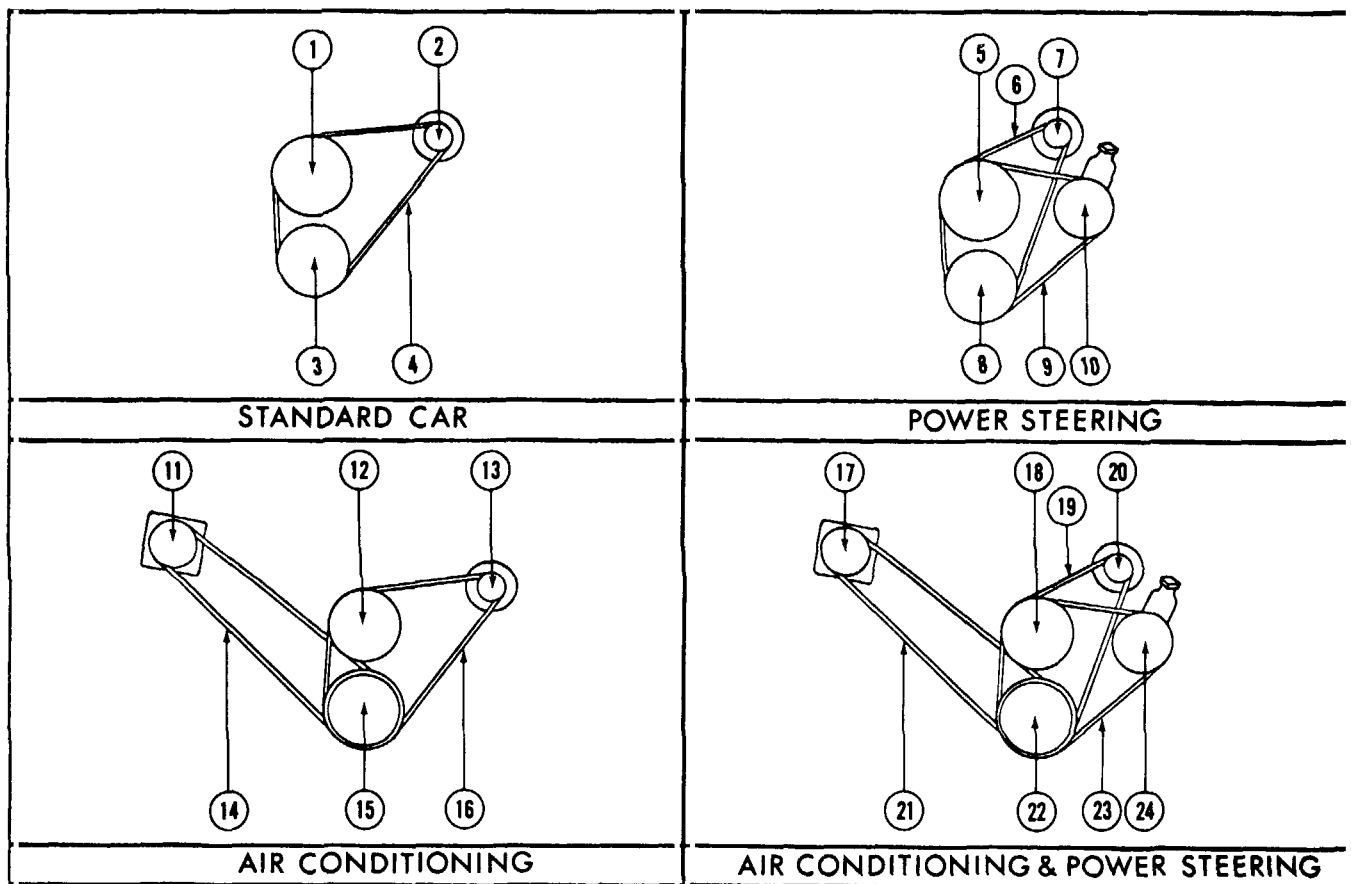

1968 FIREBIRD 8-CYL. ENGINE PULLEY & BELT APPLICATION

KEY	GROUP NO.	PART NO.	DESCRIPTION	SIZE
1	1.062	9786819	PULLEY (1-Groove)	8" Dia.
2	2.274	1949357	PULLEY (1-Groove)	2 3/4" Dia.
3	0.659	9790839	BALANCER (Less Pulley)	6 13/16" Dia.
	0.659	9790947	PULLEY (1-Groove)	7 1/4" Dia.
4	1.066	9433748	BELT	3/8" x 47 1/2"
5	1.062	9786819	PULLEY (2-Groove)	8" Dia.
6	1.066	6263720	BELT EXC. AT	3/8" x 50"
	1.066	9433752	BELT WITH AT	3/8" x 49 1/2"
7	2.274	1949357	PULLEY (1-Groove)	2 3/4" Dia.
8	0.659	9790839	BALANCER (Less Pulley)	6 13/16" Dia.
	0.659	9790846	PULLEY (2-Groove)	7 3/16" Dia.
9	1.066	3881871	BELT	3/8" x 52"
10	6.655	9786900	PULLEY	5 3/8" Dia.
11	9.180	5914730	PULLEY & BEARING ASM.	4 7/8" Dia.
12	1.062	9788886	PULLEY	5 11/16" Dia.
13	2.274	1949357	PULLEY (1-Groove)	2 3/4" Dia.
14	1.066	9433731	BELT	1/2" x 59"
15	0.659	9790839	BALANCER (Less Pulley)	6 13/16" Dia.
	0.659	9790843	PULLEY (1-Groove)	7 5/16" Dia.
	0.659	9790842	PULLEY (2-Groove)	8" Dia.
16	1.066	9433748	BELT	3/8" x 47 1/2"
17	9.180	5914730	PULLEY & BEARING ASM.	4 7/8" Dia.
18	1.062	9788886	PULLEY (2-Groove)	5 11/16" Dia.
19	1.066	9433752	BELT	3/8" x 49 3/8"
20	2.274	1949357	PULLEY (1-Groove)	2 3/4" Dia.
21	1.066	9433731	BELT	1/2" x 59"
22	0.659	9790839	BALANCER (Less Pulley)	6 13/16" Dia.
	0.659	9790843	PULLEY (1-Groove)	7 5/16" Dia.
	0.659	9790842	PULLEY (2-Groove)	8" Dia.
23	1.066	3394245	BELT	1/2" x 53"
24	6.655	9786900	PULLEY	5 7/8" Dia.



FIREBIRD

PARTS CATALOGUE

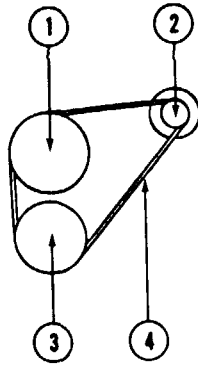

STANDARD CAR

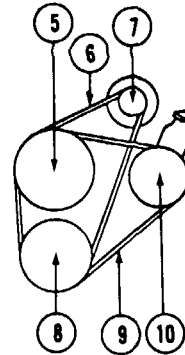

POWER STEERING

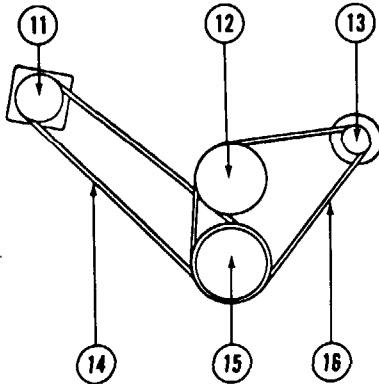

AIR CONDITIONING

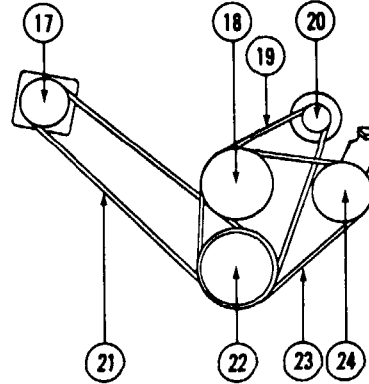

AIR CONDITIONING & POWER STEERING

1969 FIREBIRD 8 CYL. ENGINE PULLEY & BELT APPLICATION

Key	Group No.	Part No.	Description	Size
1	1.062	9796060	Pulley (1-Groove)	8" Dia.
2	2.274	1949357	Pulley (1-Groove)	2 3/4" Dia.
3	0.659	9790839	Balancer (Less Pulley) Exc. Ram Air	6 13/16" Dia.
		9794058	Balancer (Less Pulley) Ram Air	6 13/16" Dia.
		9790947	Pulley (1-Groove)	7 1/4" Dia.
4	1.066	9433748	Belt	3/8" x 47 1/2"
		9796060	Pulley (2-Groove)	8" Dia.
5	1.062	9796060	Pulley (2-Groove)	3/8" x 50"
6	1.066	9433753	Belt	2 3/4" Dia.
7	2.274	1949357	Pulley (1-Groove)	6 13/16" Dia.
8	0.659	9790839	Balancer (Less Pulley) Exc. Ram Air	6 13/16" Dia.
		9794058	Balancer (Less Pulley) Ram Air	6 13/16" Dia.
		9790846	Pulley (2-Groove)	7 3/16" Dia.
9	1.066	9433757	Belt	3/8" x 52"
10	6.655	9786900	Pulley	5 7/8" Dia.
11	9.180	5914730	Pulley & Brg. Asm.	4 7/8" Dia.
12	1.062	9796062	Pulley (2-Groove) Exc. F/8 HT400 Less V.P. Fan	7 3/16" Dia.
13	1.062	9796061	Pulley (2-Groove) F/8 HT400 Less V.P. Fan	6 1/2" Dia.
		1949357	Pulley (1-Groove)	2 3/4" Dia.
14	1.066	3391916	Belt	1/2" x 59 1/2"
15	0.659	9790839	Balancer (Less Pulley)	6 13/16" Dia.
		9790843	Pulley (1-Groove)	7 3/16" Dia.
		9790842	Pulley (2-Groove)	8" Dia.
16	1.066	9433748	Belt	3/8" x 47 1/2"
		5914730	Pulley & Brg. Asm.	4 7/8" Dia.
17	9.180	5914730	Pulley & Brg. Asm.	4 7/8" Dia.
18	1.062	9796062	Pulley (2-Groove) Exc. F/8 HT400 Less V.P. Fan	7 3/16" Dia.
		9796061	Pulley (2-Groove) F/8 HT400 Less V.P. Fan	6 1/2" Dia.
19	1.066	9433731	Belt	15/32" x 49 1/2"
20	2.274	1949357	Pulley (1-Groove)	2 3/4" Dia.
21	1.066	9782705	Belt	1/2" x 59"
22	0.659	9790839	Balancer (Less Pulley)	6 13/16" Dia.
		9790843	Pulley (1-Groove)	7 3/16" Dia.
		9790842	Pulley (2-Groove)	8" Dia.
23	1.066	9433757	Belt	15/32" x 52 1/2"
		9433758	Belt	15/32" x 53 1/2"
24	6.655	9786901	Pulley	7 3/32" Dia.



FIREBIRD PARTS CATALOGUE

1967 FIREBIRD RADIATOR SERVICE PART NUMBER AND CODE IDENTIFICATION CHART (Group 1.219)

UG 3010176	UP 3014090	UR-US 3010179	UM-UU <u>3010181</u>	UW 3014096
	UQ 3014090	UT 3010176	UV 3014096	UX 3014096

1967 FIREBIRD RADIATOR USAGE CHART

Transmission	Series & Regular Production Options	STANDARD						HEAVY DUTY RADIATOR						AIR CONDITIONING					
		ENGINE						ENGINE						ENGINE					
		230		326		400		230		326		400		230		326		400	
		1 Bbl.	4 Bbl.	2 Bbl.	4 Bbl.	Sport Option	Ram Air	1 Bbl.	4 Bbl.	2 Bbl.	4 Bbl.	Sport Option	Ram Air	1 Bbl.	4 Bbl.	2 Bbl.	4 Bbl.	Sport Option	Ram Air
Manual Trans.	2337 2367	UT	UG	-	-	-	-	UG	US	-	-	-	-	US	US	-	-	-	-
	2337 2367	-	-	UU	UU	UQ	UQ	-	-	UM	UM	UQ	-	-	-	UQ	UQ	UQ	-
Auto- matic Trans.	2337 2367	UT	UT	-	-	-	-	UG	UG	-	-	-	-	US	US	-	-	-	-
	2337, 2367 Exc. A.I.R.	-	-	UV	UW	UP	UP	-	-	UW	UX	UP	-	-	-	UP	UP	UP	-
	2337, 2367 With A.I.R.	-	-	UW	UW	UP	UP	-	-	UX	UX	UP	-	-	-	UP	UP	UP	-
Hydra- matic	2337 2367	-	-	-	-	UP	UP	-	-	-	-	UP	-	-	UR	-	-	UP	-

1968 FIREBIRD RADIATOR SERVICE PART NUMBER AND CODE IDENTIFICATION CHART (Group 1.219)

UE-UA 3010179	UF 3010179	UQ 3014090	US 3010179	UW 3010181
ZA-UB 3010179	UP 3014090	UR 3010179	UU 3010181	UX 3010181

1968 FIREBIRD RADIATOR USAGE CHART

Transmission	Series & Regular Production Options	STANDARD							HEAVY DUTY RADIATOR							AIR CONDITIONING						
		ENGINE							ENGINE							ENGINE						
		250		350		400			250		350		400			250		350		400		
		1 Bbl.	4 Bbl.	2 Bbl.	4 Bbl.	Sport Option	Ram Air	H.O.	1 Bbl.	4 Bbl.	2 Bbl.	4 Bbl.	Sport Option	Ram Air	H.O.	1 Bbl.	4 Bbl.	2 Bbl.	4 Bbl.	Sport Option	Ram Air	H.O.
Manual Trans.	23	UE or UA	UE or UA	-	-	-	-	-	UF	UF	-	-	-	-	-	US	-	-	-	-	-	-
	23	-	-	UU	UU	UQ	UQ	UQ	-	-	UX	UX	UQ	-	UQ	-	-	-	-	-	-	-
Auto- matic Trans.	23	ZA or UB	ZA or UB	UW	UW	-	-	-	UF	UF	UX	UX	-	-	UR	-	UP	UP	-	-	-	
Hydra- matic Trans.	23	-	-	-	-	UX	UP	UP	-	-	-	-	UP	-	UP	-	-	-	UP	-	UP	

1969 RADIATOR CHART (GROUP 1.219)

SERIES	ENGINE		STANDARD		HEAVY † DUTY RADIATOR		AIR COND. RADIATOR		SUPER COOLING RADIATOR	
	CUBIC INCH	DESCRIPTION	M.T.	A.T. or H.T.	M.T.	A.T. or H.T.	M.T.	A.T. or H.T.	M.T.	A.T. or H.T.
223	6-CYL 250	1BBL.STD.	UE	ZA	ZC	ZC	ZC	ZC	N/A	N/A
		4BBL.	UE	ZA	ZC	ZC	N/A	N/A	N/A	N/A
	8-CYL. 350	2BBL.	UU	UW	UJ	UP	UQ	UP	N/A	N/A
		4BBL.	UU	UW	UJ	UP	UQ	UP	N/A	N/A
	8-CYL. 400	SPORT OPT	UJ	UW	UQ	UP	UQ	UP	N/A	N/A
		HO	UJ	UW	UQ	UP	UQ	UP	N/A	N/A
		RAM AIR	UQ	UP	N/A	N/A	N/A	N/A	N/A	N/A

† FIREBIRD REQUIRES H.D. RADIATOR WITH AXLE RATIOS ABOVE 3.55
N/A NOT AVAILABLE

SERVICE RADIATORS

UE-ZA USE 3010179	ZC USE 3010179	UU-UW-UX USE 3010181
UP-UQ USE 3014090	UJ-UM USE 3010181	

1970-71 RADIATOR CHART (GROUP 1.219)

SERIES	ENGINE		STANDARD		HEAVY † DUTY RADIATOR		AIR COND. RADIATOR		SUPER COOLING RADIATOR		
	CUBIC INCH	DESCRIPTION	M.T.	P.G. or H.T.	M.T.	P.G. or H.T.	M.T.	P.G. or H.T.	M.T.	P.G. or H.T.	
1 9 7 0 223	250-6 Cyl.	1 BBL	FU	FT	FW	FW	N/A	N/A	N/A	N/A	
	350 - V-8	2 BBL	FK	FL	FM	FM	FP	FM	N/A	N/A	
	400 - V-8	2 BBL	N/A	* FO	N/A	FM	FM	N/A	FX\$	N/A	N/A
		4 BBL	FN	* FO	FM	FM	FP	FX\$	N/A	N/A	
		RAM AIR III	FM	FM	FP	FS	FP	FS	NA	NA	
		RAM AIR IV	FP	FS	N/A	N/A	N/A	N/A	N/A	N/A	
1 9 7 1 223	250-6 Cyl.	1 BBL	FU	FT	FW	FW	N/A	N/A	N/A	N/A	
	350 - V-8	2 BBL	FC	FL	FP	FM	FP	FM	N/A	N/A	
	400 - V-8	2 BBL	N/A	FL	N/A	FM	N/A	FM	N/A	N/A	
		4 BBL	FV#	FY	FP	FM	FP	FZ	N/A	N/A	
	455 - V-8	4 BBL	N/A	FM	N/A	FS	N/A	FS	N/A	N/A	
		4 BBL HO	FF	FM	FP	FS	FP	FZ	N/A	N/A	

† - H.D. RAD REQUIRED WITH AXLE RATIOS ABOVE 3.55
 * - FM RAD MUST BE USED WITH PERFORMANCE AXLE RATIOS
 \$ - FS RAD MUST BE USED WITH PERFORMANCE AXLE RATIOS
 # - USE FP RAD WITH CLOSE RATIO 4 SPD TRANS.
 N/A - NOT AVAILABLE

SERVICE RADIATORS

FU - FT - FW USE 3022831	FK - FL - FC USE 3021527	FM - FN - FO - FV USE 3021528	FP - FX - FS - FZ USE 3021532
FF - FY USE 3023920			

1972 RADIATOR CHART – GROUP 1.219

ENGINE	STANDARD		HEAVY DUTY RAD.		AIR CONDITIONING	
	MANUAL TRANS.	AUTO. TRANS.	MANUAL TRANS.	AUTO. TRANS.	MANUAL TRANS.	AUTO. TRANS.
6 CYL.	DM	DL	DP	DP	–	–
350 V-8	HM	FA	FH	FB	FH	FB
400/2BC/V-8	–	FA	–	FB	–	FB
400/4BC/V-8	HM	FJ	FH	FB	FH	FI
455 H.O. V-8	HM	FB	FH	FI	FH	FI

SERVICE RADIATORS		
DL – USE 3025068	FA – USE 3025915	FH – USE 3025900
DM – USE 3025068	FB – USE 3025900	FI – USE 3025900
DP – USE 3025068	HM – USE 3025915	FJ – USE 3025915

1973 RADIATOR CHART – GROUP 1.219

ENGINE	STANDARD		HEAVY DUTY RAD.		AIR CONDITIONING	
	Manual Trans.	Auto Trans.	Manual Trans.	Auto Trans.	Manual Trans.	Auto Trans.
6 Cyl.	DA	DK	DC	DC	—	—
350 V-8	FR	FS	FT	FU	FT	FU*
400/2BC/V-8	—	FS	—	FU	—	FU*
400/4BC/V-8	FR	FS	FT	FW	FT	FW
455 V-8 Exc. S.D.	FX	FU	FT	FW	FT	FW
455 S.D. V-8	FX	FU	FT	FW	FT	FW

* When Special Radiator Option (VO5) is specified use Radiator Code FW.

SERVICE RADIATORS		
DA—Use 3025068	FR—Use 3023920	FU—Use 3025900
DC—Use 3027942	FS—Use 3027946	FW—Use 3032109
DK—Use 3025068	FT—Use 3032109	FX—Use 3025900



1974 RADIATOR CHART — GROUP 1.219

ENGINE	STANDARD		HEAVY DUTY RAD.		AIR CONDITIONING	
	Manual Trans.	Auto Trans.	Manual Trans.	Auto Trans.	Manual Trans.	Auto Trans.
6 Cyl.	DM	DN	DP	DP	—	—
350 V-8	FL	FH	FA	FI	FA	FI
400/2BC/V-8	—	FN	—	FO	—	FO
400/4BC/V-8	FM	FK	FA	FB	FA	FB
455 V-8 Exc. S.D.	FM	FK	FA	FC	FA	FC
455 S.D. V-8	FM	FY	FA	FC	FA	FC

SERVICE RADIATORS

DM—Use 3025068	FC—Use 3030111	FM—Use 3030837
DN—Use 3025068	FH—Use 3030837	FN—Use 3030837
DP—Use 3025068	FI—Use 3030836	FO—Use 3030111
FA—Use 3030111	FK—Use 3030837	FY—Use 3030836
FB—Use 3030111	FL—Use 3030837	

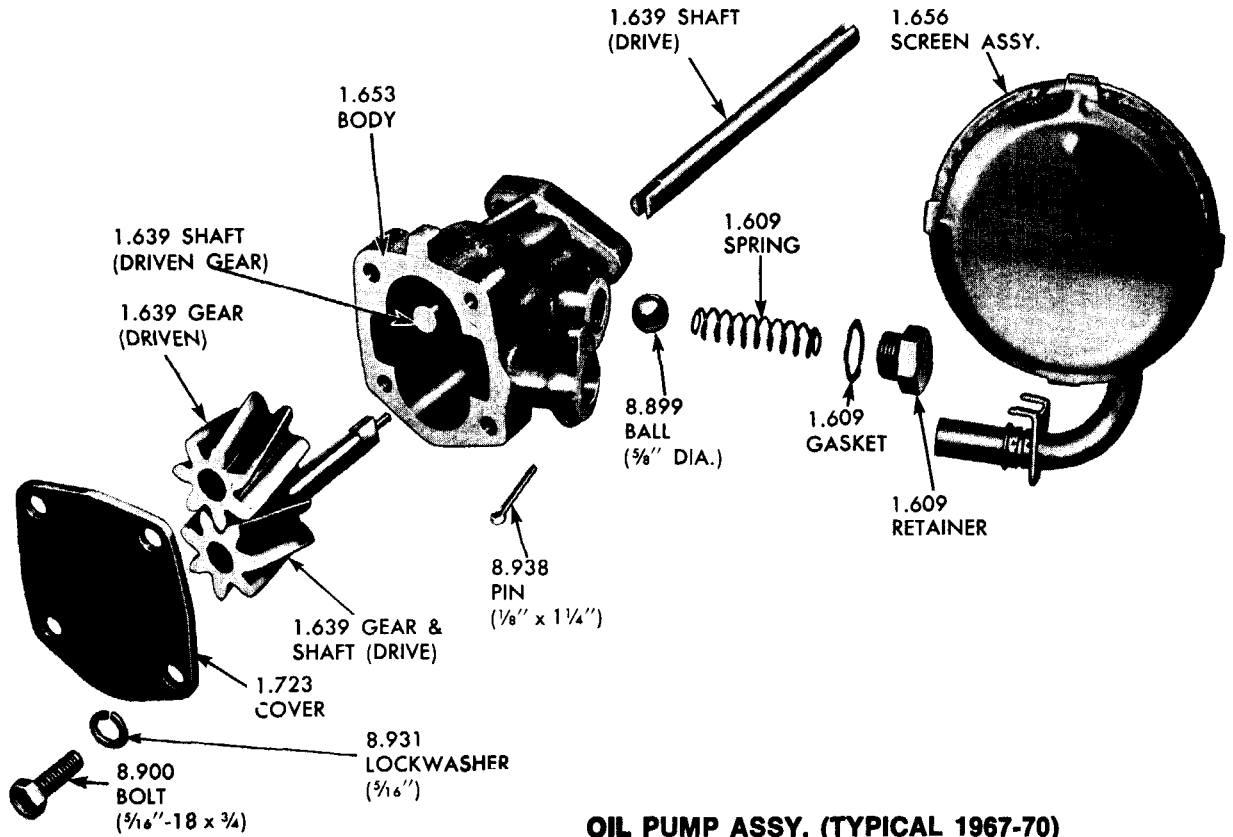

OIL PUMP ASSY. (TYPICAL 1967-70)

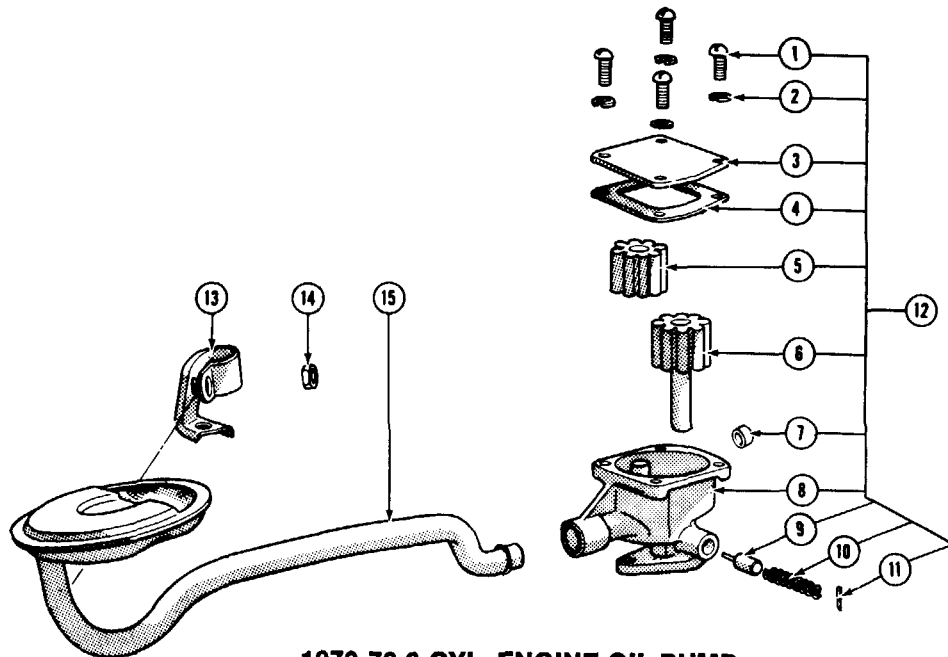

1970-76 6-CYL. ENGINE OIL PUMP

Key	Part Name	Group No.	Key	Part Name	Group No.
1	SCREW, Cover to Body (1/4"-20 x 5/8")	8.977	9	VALVE, Oil Pressure Regulator	1.609
2	LOCKWASHER, Cover to Body (1/4")	8.931	10	SPRING, Oil Pressure Regulator	1.609
3	COVER, Oil Pump Body	1.723	11	PIN, Valve & Spring Retainer (3/4"-groove)	N.S.
4	GASKET, Oil Pump Cover	1.724	12	PUMP ASM., Oil	1.652
5	GEAR, Oil Pump Driven	N.S.	13	SUPPORT, Pipe and Screen	1.656
6	GEAR, Oil Pump Drive	N.S.	14	NUT, Pipe & Screen Support (1/4"-20)	N.S.
7	PLUG, Oil Pressure Regulator Hole	1.531	15	HOUSING, PIPE & FLANGE ASM., Oil Screen	1.656
8	BODY, Oil Pump	N.S.			

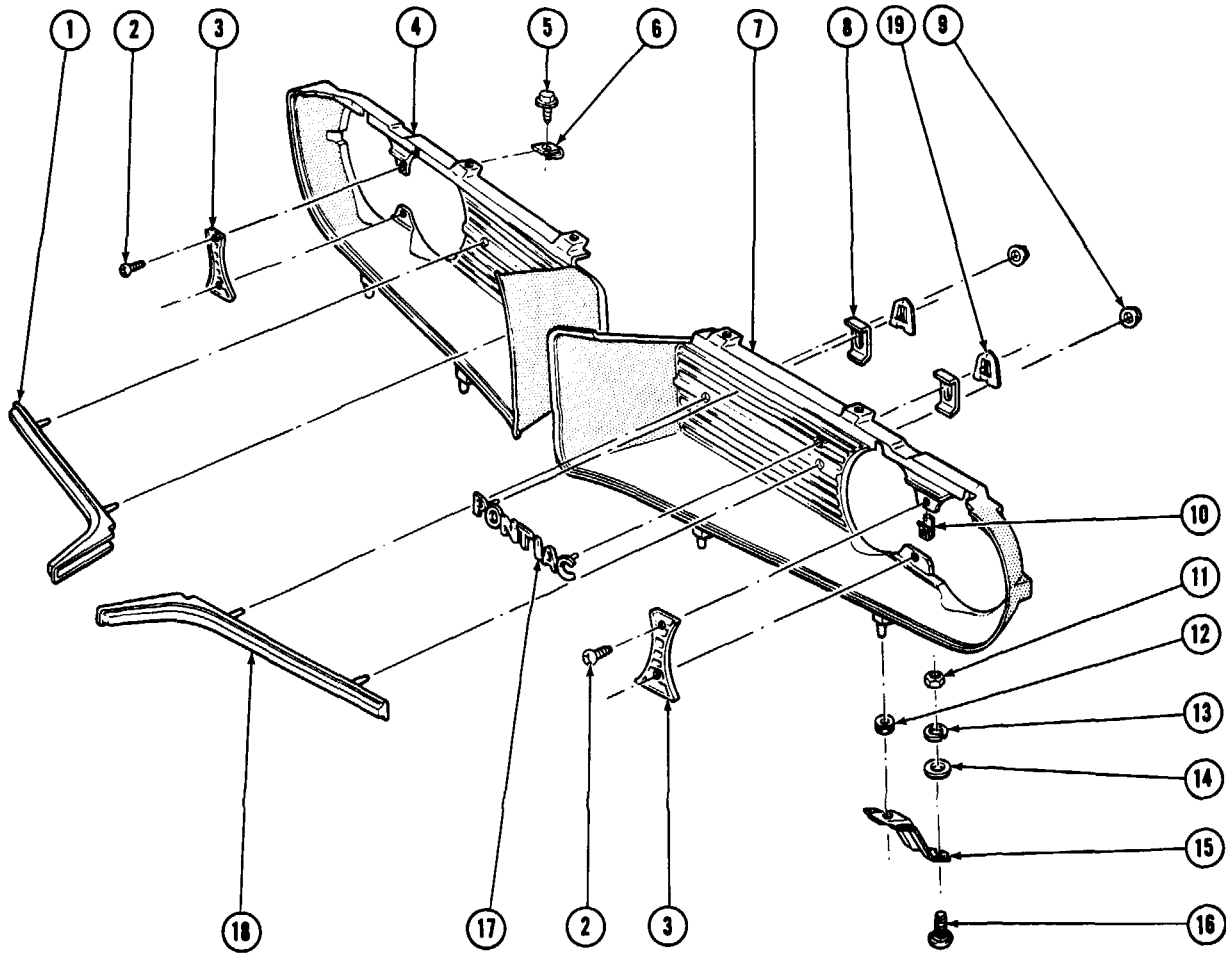

1967-68 FIREBIRD GRILLES

Key	Part Name	Group No.
1	MOLDING, Radiator Grille - R.H. (Part of 400 Sport Opt. Grille Asm.)	N.S.
2	SCREW, Escutcheon to Radiator Grille (#8-18 x 5/8")	1.269
3	ESCUTCHEON, Radiator Grille - Plastic	1.268
4	GRILLE, Radiator - R.H. (Exc. 400 Sport Opt.)	1.266
	GRILLE, Radiator - R.H. (w/400 Sport Opt.)	1.266
5	SCREW, Rad. Grille to Upper Reinforcement (1/4"-20 x 5/8")	N.S.
6	NUT, Rad. Grille to Upper Reinforcement (1/4"-20 "U" Shape)	N.S.
7	GRILLE, Radiator - L.H. (Exc. 400 Sport Opt.)	1.266
	GRILLE, Radiator - L.H. (w/400 Sport Opt.)	1.266
8	BRACKET, Radiator Grille Emblem	1.303
9	NUT, Rad. Grille Molding to Grille (1/8" Stamped)	8.921
10	NUT, Escutcheon to Radiator Grille	1.269
11	NUT, Rad. Grille Lower Stab. Brkt. to Frt. Bumper (3/8"-16)	8.915
12	GROMMET, Radiator Grille Lower Stabilizer Brkt.	1.268
13	LOCKWASHER, Rad. Grille Lower Stab. Brkt. to Frt. Bumper (3/8")	8.931
14	WASHER, Rad. Grille Lower Stab. Brkt. to Frt. Bumper (3/8")	8.929
15	BRACKET, Radiator Grille Lower Stabilizer	1.266
16	BOLT, Rad. Grille Lower Stab. Brkt. to Frt. Bumper	7.852
17	EMBLEM, Radiator Grille - Pontiac	1.303
18	MOLDING, Radiator Grille - L.H. (Part of 400 Sport Opt. Grille Asm.)	N.S.
19	RETAINER, Radiator Grille Emblem to Grille	1.303

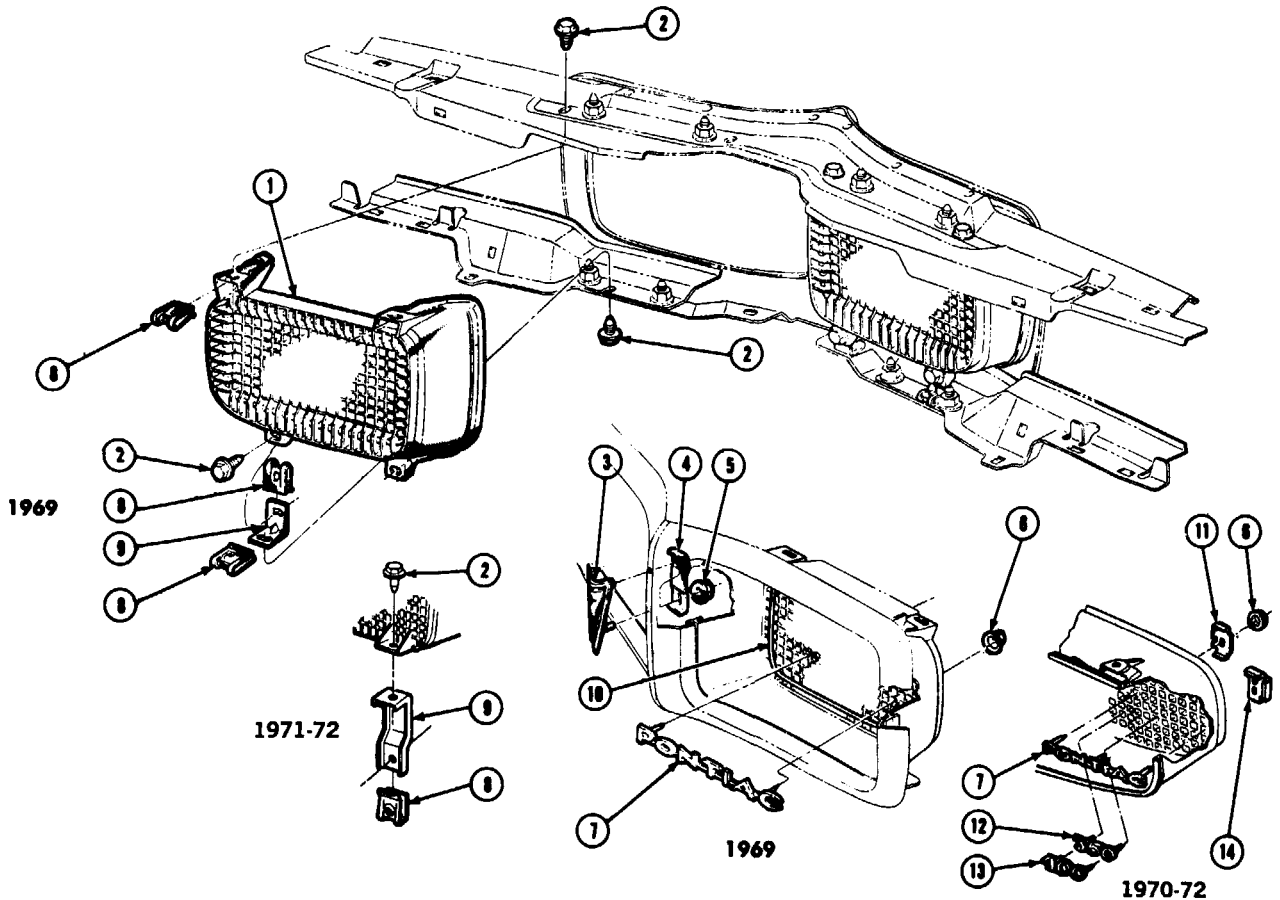

1969-72 FIREBIRD GRILLES

Key	Part Name	Group No.
1	GRILLE, Radiator - RH (Silver)	1,266
	GRILLE, Radiator - LH (Silver)	1,266
	GRILLE, Radiator - RH (Black)	1,266
	GRILLE, Radiator - LH (Black)	1,266
2	SCREW, Rad. Grille to Upper & Lower Reinf. (1/4" - 14 x 3/4")	1,269
3	EMBLEM, Front Bumper - (w/400 Sport Opt.)	7,831
4	RETAINER, Emblem to Bumper - (w/400 Sport Opt.)	7,831
5	NUT, Emblem to Bumper - (w/400 Sport Opt.) - (#10-24)	8,915
6	NUT, Name Plate to Grille - (1/8" x 7/16" O.D.)	8,921
7	PLATE, Radiator Grille Name "Pontiac"	1,303
8	NUT, Lower Grille Bracket to Panel Attach. - (1/4" - 14)	N.S.
9	BRACKET, Radiator Grille Mtg.	1,266
10	MOLDING, Radiator Grille - RH -	1,268
	MOLDING, Radiator Grille - LH -	1,268
11	RETAINER, Name Plate to Grille Attach.	1,303
12	EMBLEM PKG., Grille "350"	1,303
13	EMBLEM PKG., Grille - "400"	1,303
14	RETAINER, Grille Emblem	1,303

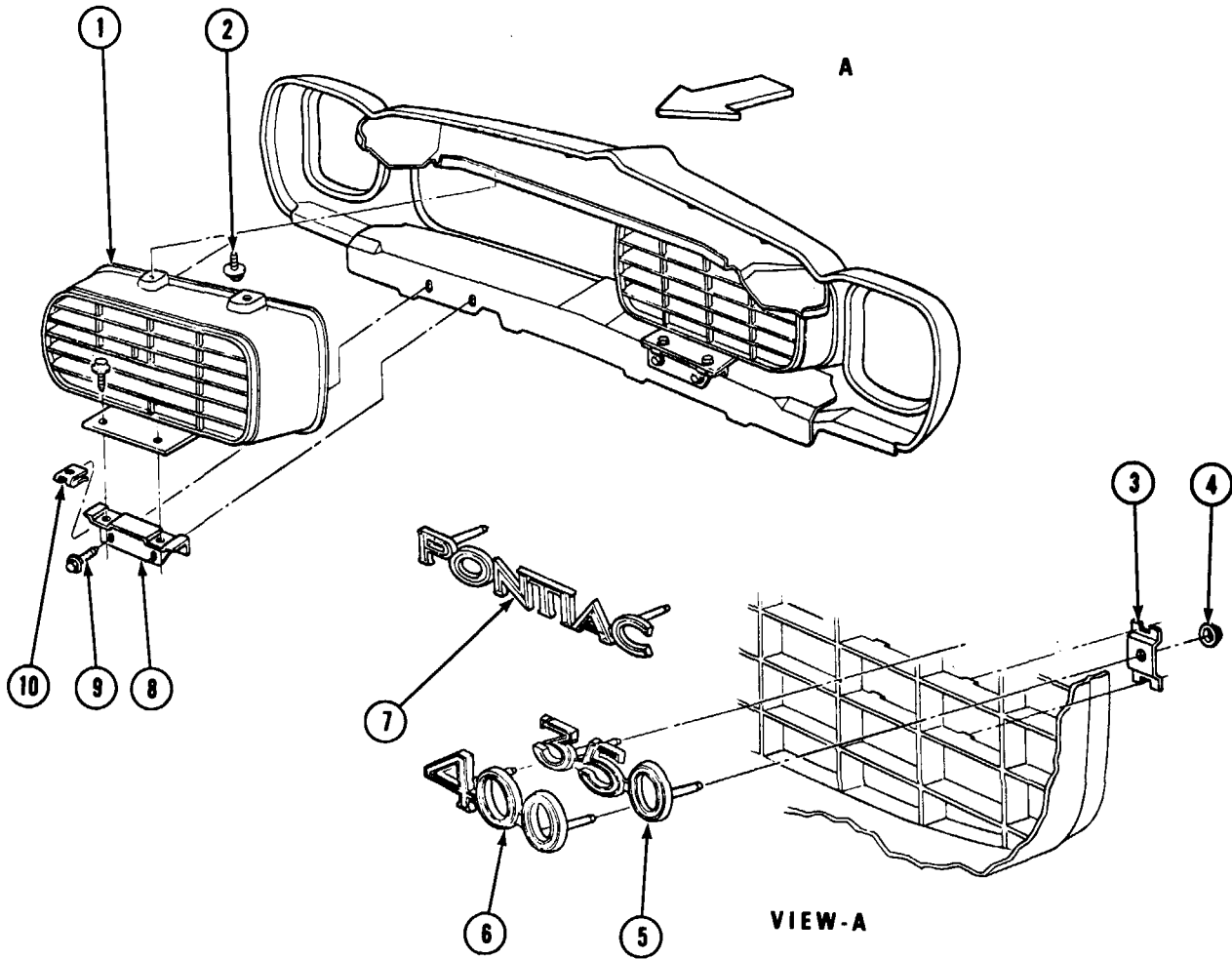

1973 FIREBIRD GRILLES

Key	Part Name	Group No.
1	GRILLE, Radiator Incl. Bezel (Standard)	1.266
	GRILLE, Radiator Incl. Bezel (With Sport Option or Trans Am)	1.266
2	SCREW (1/4"-14 x 1")	8.977
3	RETAINER, Emblem	1.303
4	NUT (1/8")	8.921
5	EMBLEM PKG., Grille "350"	1.303
6	EMBLEM PKG., Grille "400"	1.303
7	PLATE PKG., Grille "Pontiac"	1.303
8	BRACKET, Grille Mtg.	1.266
9	SCREW (1/4"-14 x 5/8")	8.977
10	NUT (1/4"-14 "U")	8.921

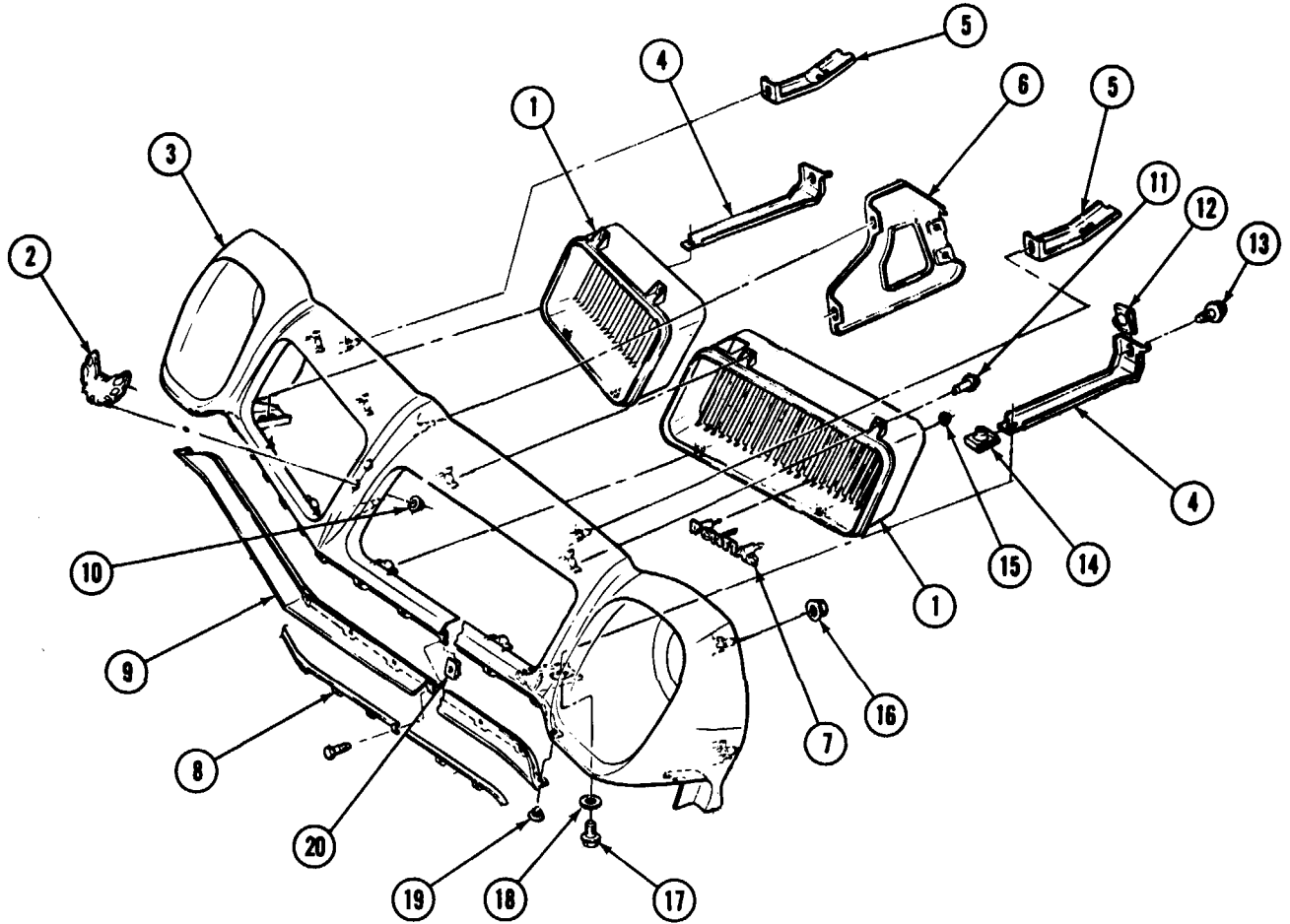

1974-75 GRILLES

Key	Part Name	Group No.
1	GRILLE, Radiator (Exc. Trans Am or Formulas)	1.266
	GRILLE, Radiator (w/Trans Am or Formulas)	1.266
2	EMBLEM PKG., Front End Panel	1.303
3	PANEL, Front End & Headlamp Mtg.	1.266
4	SUPPORT, Panel to Baffle	1.266
5	SUPPORT, Panel - Outer	1.266
6	SUPPORT, Panel - Center	1.266
7	PLATE PKG., Grille - "Pontiac"	1.303
8	RETAINER, Panel Lower Extension	1.266
9	EXTENSION, Panel - Lower	1.266
10	NUT (3/16")	8.921
11	SCREW (#8-18 x 3/4")	N.S.
12	NUT (5/16"-18 "U")	8.083
13	SCREW (5/16"-18 x 3/4")	1.276
14	NUT (5/16"-12 "U")	8.921
15	NUT (1/8")	8.921
16	NUT (5/16"-18)	N.S.
17	SCREW (5/16"-12 x 1")	N.S.
18	WASHER (5/16" I.D. x 1-1/8" O.D.)	N.S.
19	CLIP, Extension	1.274
20	NUT (#8-18 "U")	8.921



1970-75 POSITIVE CRANKCASE VENTILATOR SYSTEM

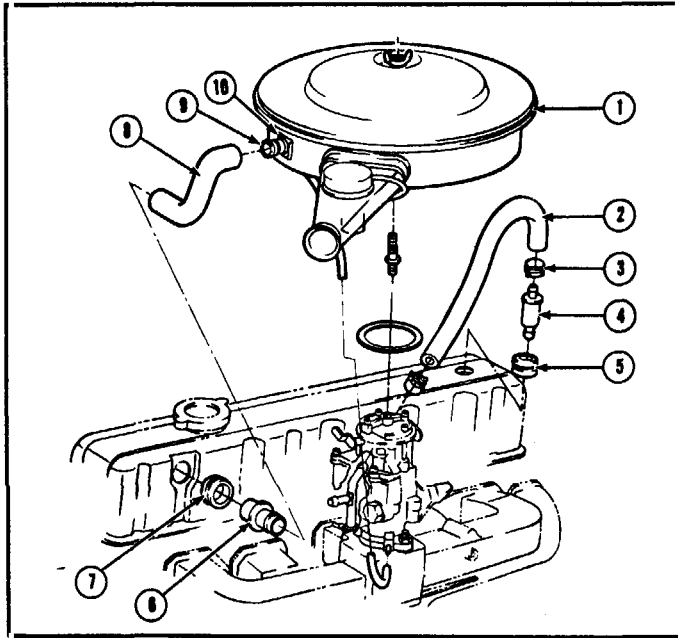

1970-75 6-CYL. ENGINE

Key	Part Name	Group No.
1	CLEANER ASM., Carb. Air	3.402
2	HOSE, Crankcase Vent	1.762
3	CLAMP, C/C Vent Hose	1.750
4	VALVE ASM., Crankcase Vent	1.745
5	GROMMET, C/C Vent Valve	1.745
6	CONNECTOR, Vent Hose to Cover	1.745
7	GROMMET, Vent Hose Connector	1.745
8	HOSE, Air Cleaner to Rocker Arm Cover	1.762
9	ELEMENT, C/C Vent Air Filter	3.410
10	RETAINER, Air Filter Element	3.410

NOTE: See Group 0.000 Illustration 6-7 for 8 Cyl. Eng. PCV Valve

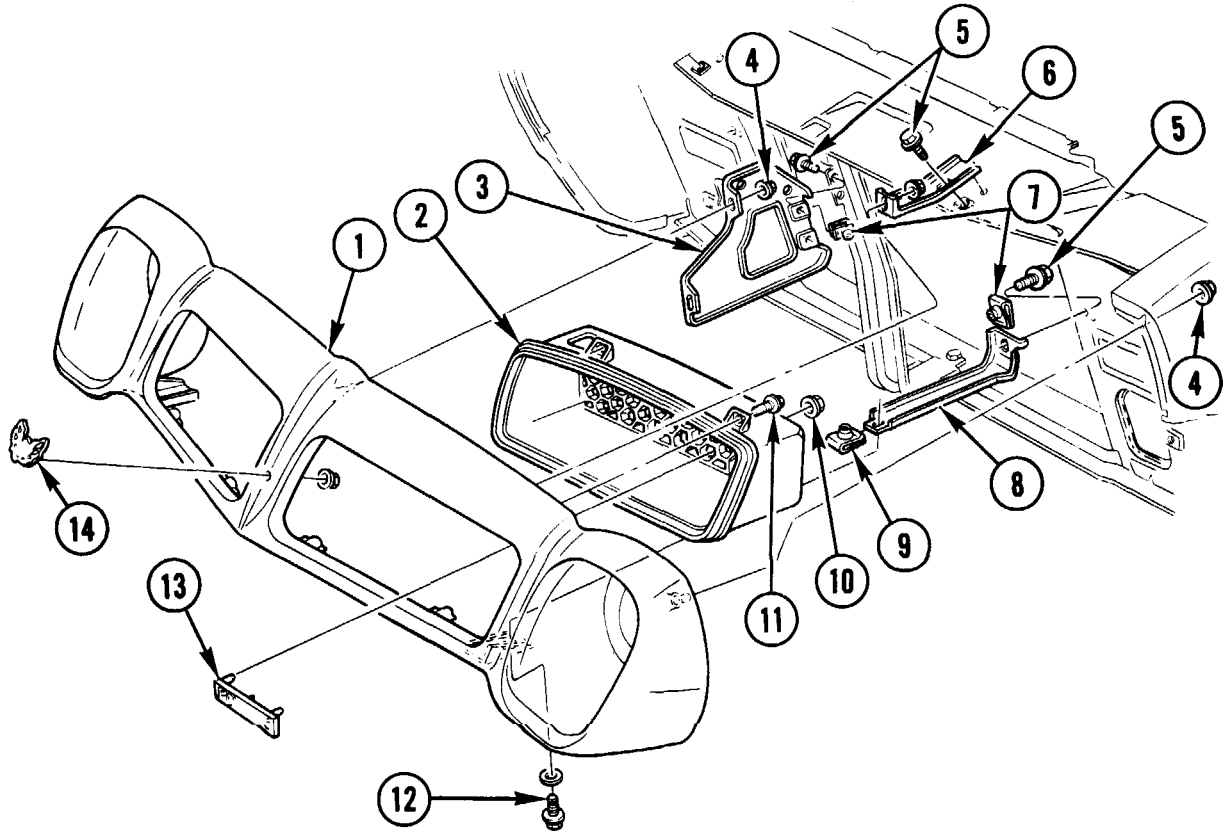

1976 RADIATOR GRILLE

Key	Description	Group
1	PANEL ASSEMBLY, Front End	1.266
2	GRILLE, Radiator	1.266
3	SUPPORT, Front End Panel — Centre	1.266
4	NUT ($\frac{5}{16}$ -18)	8.921
5	SCREW, Front Fender to Skirt and Radiator Support ($\frac{5}{16}$ -18 x $\frac{3}{4}$)	1.276
6	SUPPORT, Front End Panel — Outer	1.266
7	NUT ($\frac{5}{16}$ -18)	8.921

Key	Description	Group
8	SUPPORT, Front End Panel — to Baffle	1.266
9	NUT ($\frac{5}{16}$ -12)	8.921
10	NUT ($\frac{5}{16}$)	8.921
11	SCREW (8-18 x $\frac{3}{4}$)	8.977
12	BOLT, Radiator Support Insulator to Frame	1.269
13	EMBLEM, Radiator Grille	1.303
14	EMBLEM, Front End Panel	1.303